

Furniture for people



The Highlight: S 7000 *Prefino*



For some tasks, you simply need an expert. Such as the furnishing of changing rooms. Whenever you need a crucial "extra bonus" in terms of space, function and design – Prefino is in its element.

For the highest demands.

Do you demand the best? Do you set great store by variability and retrofitting flexibility? Is hygiene particularly important in your premises? Do you need online locking systems that are managed securely and neatly connected? Do you require solutions for creative room lighting? Then Prefino from C+P – the market leader in changing-room and cloakroom furnishing – is the perfect system for you.



Additional space:
The storage box allows you to take advantage of redundant space in the locker.



Pools and spas



Modern pools are designed to offer worlds of experience, where the visitors can find everything under one roof: A swimmer's paradise, an oasis of vitality, thermal spa and sauna worlds and a range of shopping and catering facilities. The changing areas need to meet special requirements, which can range from attractive glass doors to electronic online locking systems. Prefino has the right products to meet all requirements.



Brilliantly equipped:
Mirror blanking panels with illumination and trays to ensure the best possible utilisation of the front side.



Sports, fitness and wellness facilities

Hospitals and clinics



What is the first thing you see after checking in? The changing rooms. Appealing and versatile fittings can be a superb advertisement for the facilities. Prefino makes a definite statement with a wide range of options: Flexible configurations, special motifs to individualise the design, interesting light moods created by the room lighting integrated into the locker roof – and much, much more.

Hygiene, cleanliness and safety are important factors in medicine and healthcare. Prefino is easy to clean and decontaminate, and provides specific solutions for all areas – staff or operating changing areas, or security compartments for the patients – together with a wide range of matching add-on furniture.



Refreshing:
Prefino bag locker with glass fronts, glass cover plate and integrated drinking water fountain.

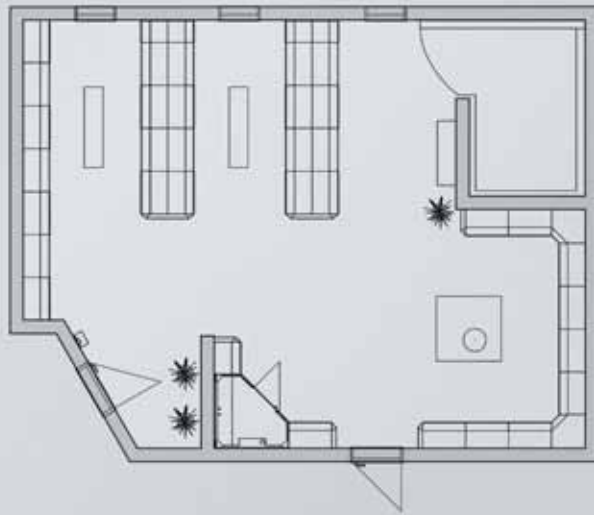

2-D room planning

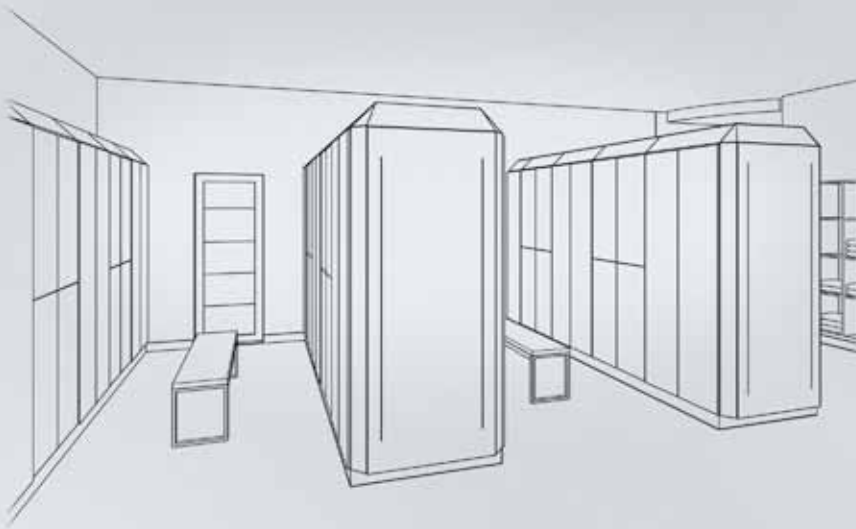

3-D room planning



Ideas. Planning. Solutions.

Prefino locker systems do not just blend perfectly into the overall architecture, they can even play a role in shaping the same, thus creating an incomparable impression. One example of this is the locker roof with integrated room lighting, which can be individually controlled.





Photorealistic visualisation

C+P offers practical solutions for creative room planning – from easy-to-use planning tools right up to animated 3-D visualisation. You will be amazed at just how much you can do with Prefino!







Unique

Individual motifs in the glass fronts give your changing areas a distinctive appearance.

Matching benches:
The Vitas range of benches highlights any top-class surroundings.



Creative front design:
The sturdy steel system carcass is an ideal basis for creative door designs made from the widest range of materials.



Steel/Stainless steel

A relaxing visit to a wellness or spa facility starts in the changing room. You will never have a second chance to create this first impression. So here in particular – and regardless of the size of the facility – you need a special atmosphere.

Wellness. Spa. Prefino.



Folding shelf:
It offers sufficient room for everything while still leaving enough space to hang your clothes.

Elegant and functional:
Prefino bag locker with glass fronts and cover plate, and stainless steel insert.



HPL decor



Real-wood veneer



Glass



Glass with motif print



HPL with vectogram

There are two sides to Prefino: One is the top quality design with the widest choice of shapes, materials and colours to create an ambience of well-being. The other is the practical accessories and sophisticated technology for smooth and comfortable operation.



Glass shelves:
A sophisticated solution: shelves made of 8 mm-thick toughened safety glass (with optional lighting) add another touch of style to the interior.



Lots of storage space:
Enough room for everything at last! The 800 mm deep Prefino bag locker can even store a large sports bag without any problems.



Versatile technology panel:
The locker sides can be used for mirror blanking panels, hairdryer trays or LED lighting.





Illuminating

Sources of light in the roof of a Prefino locker can enhance or even replace the room lighting.





Installation sloping top:
Lots of space for functional ideas – from the laying of necessary ventilation and supply lines through to the complete integration of indirect room lighting.

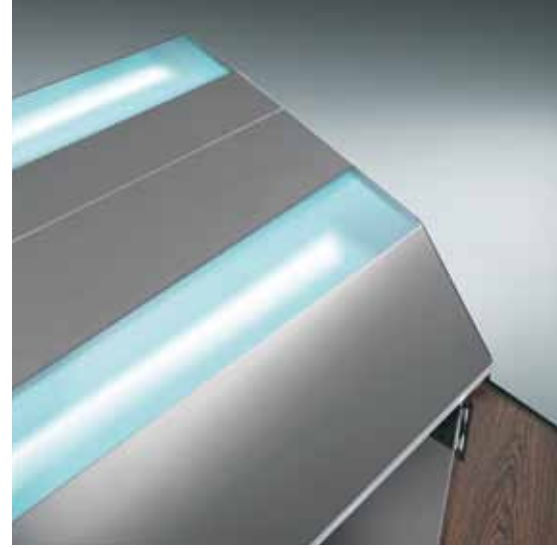

All-rounder:
Variable compartment sizes, LED lighting and LCD monitor integrated in the mirror panel – Prefino can meet all your fitting requirements.

Accentuated mood lighting can enable you to create impressions that are unparalleled. Prefino cloakroom lockers can help you achieve the desired effect!

Fitness for the eye.

Feel free to entrust the entire room lighting to Prefino's innovative installation sloping roof. It can cope with anything from simple indirect lighting right up to individually controllable RGB lighting that you can use to create any light mood you require. Prefino opens up a whole new dimension of optical room enhancement!



Double coat hooks:
Immensely convenient, with integrated system for coat hangers.



Security compartment:
Instead of the hat compartment. Available for compartment widths of 300 and 400 mm.



Mood lighting:
 RGB light modules are also optionally available. The three primary colours can be used to create a wide range of different light moods.

The RGB (red, green, blue) lighting can be integrated into Prefino's sloping roof and the three light colours mixed with the help of a control unit to create any light mood you require. You can even create different light scenarios to match different times of the day, thus ensuring that your changing room has an impressive impact on all your visitors!



Practical tip

Professional light planning:

Various factors need to be taken into consideration when planning room lighting, together with any statutory requirements, such as minimum lighting intensity. A layout plan is used to incorporate the sources of light.

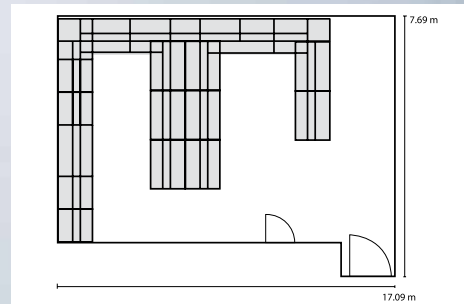

2-D room planning

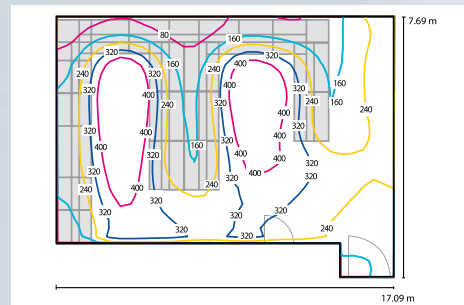

Light planning using ISO lines for indicating lighting intensities in Lux at any point of the room

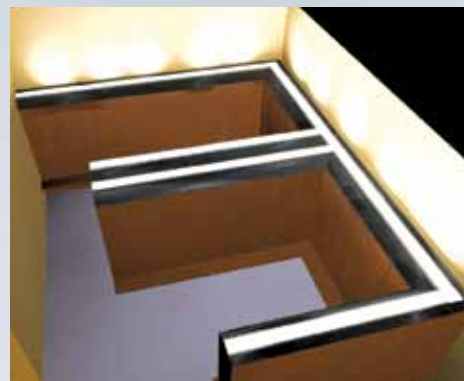

3-D room planning (visualisation of light distribution)

Ask the experts for advice! C+P offers professional light planning as one of its services.





Elegant

Enamelled glass doors are easy to clean and create an impression of quality.



Numbering and orientation:
Colour matching inscriptions and pictograms are available to ensure optimal room orientation and numbering.

The widest range of sub-frames is used in locker systems, depending on the building concept. Prefino is flexible – and therefore ideally suited, no matter what the requirements are.

Take a seat!



In addition to the classic feet or bases, integrated bench solutions are becoming increasingly popular. Benches are available to surround the lockers on an on-site base, for installation in front of lockers with shortened doors, or with storage boxes incorporated beneath them. Prefino is the best choice to achieve the ideal result.



Bench with incorporated storage box:
The seat also acts as a locking flap, which can only be opened by the person using the locker. The storage box provides convenient storage and easy access to bags, helmets, and much, much more.



All of the sub-frames shown here are extremely easy to clean – not least thanks to the clean-cut design of the corners. So you can enhance the hygiene in the room while at the same time benefitting from easy, fast and therefore lower-cost cleaning. The version with incorporated storage box makes use of the previously unused space to provide additional storage, thus offering the visitors genuine added benefit.



Integrated bench with HPL seat:
Both this bench and the version with storage box incorporated beneath it can be retrofitted if required.





Hygienic

*Cleanliness and hygiene
are the foremost
priorities in clinics.*



Clinic and hospital fittings must meet very high standards of hygiene, especially in intensive care, the operating theatre or the quarantine area. One of the requirements is the resistance of the furniture to disinfectants.

For effective clinic hygiene.

Profino offers more: Smooth interior and outside locker walls make cleaning and decontamination child's play. The zinc-plated steel carcass with its annealed coating offers additional benefits in terms of hygiene and cleaning. Internal and external corners that fit perfectly ensure that the lockers systems have clean ends.



Smooth interior walls:
All of the interior walls are uniformly smooth – making them convenient to use and easy to clean effectively.



Swing flap:
For easy loading of the laundry collector.



Laundry bag holder:
The standard version has four sturdy retaining hooks (centre picture); a convenient holder with telescopic pull-out is also available for easier removal of the laundry bag.

A further issue that hospitals need to address is the provision of fresh laundry and the handling of dirty laundry. Here, again, Prefino has just the right products – from shelves for issuing fresh laundry right up to laundry collectors with swing deposit flap and telescopic pull-out for the laundry bag. The range is completed by matching box lockers.



Box locker:
Three lockers on top of each other, two lockers next to each other, compartment width 400 mm.



Box locker:
Four lockers each on top of each other and next to each other, compartment width 300 mm.



Laundry collector:
With HPL door, upper swing flap and laundry bag holder on the inside.



Fresh

Prefino lockers are easy to connect to on-site ventilation and extraction systems.





The requirements placed on locker systems used in hygiene areas (e.g. in the food industry) are particularly stringent - in much more than just one respect: For one thing, the surfaces must be smooth and easy to clean. The steel carcass with smooth interior walls gives Prefino a clear edge.

A clean solution.

Another aspect is the connection of existing ventilation or extraction systems, which needs to be resolved professionally. Added to which, suitable add-on products are needed, such as swivel benches for the staff to move from the "unclean" to the "clean" area. C+P has just the right range for solving these fitting challenges.



Assembled box locker with HPL doors:
The HPL doors are also available in attractive wood decors.



Swivel bench:
This bench marks the transition from the unclean to the clean area. Outdoor shoes are left behind on the unclean side.





Drying facility in the technology compartment:
The drying unit is completely integrated into the locker, and can be programmed and easily adjusted.

C+P offers a range of ventilation and extraction concepts that all reflect the latest state of technology – from self-ventilating (SVL) to classic forced ventilation (FVL) right up to forced ventilation with dryer (FVLD). The drying units are housed in the technology compartments within the locker system.



Technology compartment with dryer:
The sizing of the drying and ventilation system is dictated by the local conditions and the drying tasks that need to be performed.

Practical tip

Something to bear in mind with regard to ventilation:

Before deciding on a ventilation system, ask for advice on the most cost-efficient solution for your needs. An overview of the C+P concepts:



Self ventilation concept:

Can be used for 90% of all drying tasks! Depending on the moisture content, the clothing is dried in 6-14 hrs. The ambient temperature should be approx. 20° C with relative air humidity of approx. 50% (normal climate in Central Europe).

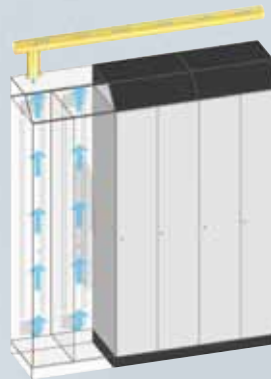

Forced ventilation concept:

Can be used wherever emissions need to be eliminated and normal drying tasks performed. Depending on the moisture content, the clothing is dried in 6-14 hrs. The ambient temperature should be approx. 20° C with relative air humidity of approx. 50% (normal climate in Central Europe).

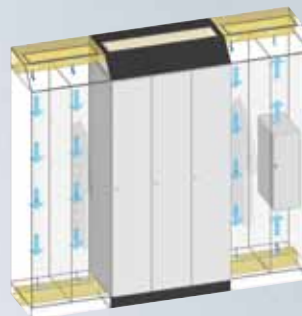

Forced ventilation concept with drying:

Can be used whenever a large quantity of wet clothing needs to be dried in a short time. Depending on the moisture content, the clothing dries in just a few hours.

More sophisticated solutions for hygiene areas (e.g. integrating filter and disinfection systems) are possible. Please do not hesitate to consult us for advice on your specific project!

Well thought through.

The difference is in the detail! S 7000 Prefino offers much more than you expect. Clever and well thought through – typical C+P.

Elegant to look at – easy to clean



Smooth outer door surfaces:
Internal hinges give the lockers a clean appearance – even if they have glass doors.



Smooth interior walls:
Clean and hygienic – easy to clean and decontaminate.

Safety



Security compartment:
Instead of the hat compartment. Available for compartment widths of 300 and 400 mm.



Safe with PIN code lock:
The sturdy safe is firmly installed and offers safe protection of all valuables.



Accessories on the door



Towel holder:
For compartment width 300 mm, for fastening to right-hinged doors.



Towel and shower gel holder:
For compartment width 400 mm, for fastening to right-hinged doors.

Accessories on the door



Mirror:
Mirror available in two sizes (90 x 100 or 200 x 300 mm).



Flip-flops and shoe holder:
For compartment width 300/400 mm.

Mechanical locking systems



Cylinder lock with 2 keys:
With cylinder barrel, pin cylinder or sheet lock. Optionally available with master key function.



Safety turning bolt:
The locking mechanism cannot be damaged by over-rotation since the lock cylinder does not snap into place until the padlock has been removed.



Mechanical locking systems



SAFE-O-MAT lock:
With convenient twin coin deposit lock...



...or as token-operated lock:
With large cashbox (twin-coin multiuse).



Ticket-operated locks:
The practical solution found at many swimming pools: the admission ticket dispensed by the machine also serves as a deposit. Staff IDs or club membership cards can also be used.



Electronic offline locking systems



PIN lock:
The simple solution with individually selectable PIN. Ideal wherever keys or data carriers are not wanted.



Digilock locking system:
Programmable system with freely selectable PIN and additional locking options.



GAT-Lock 6010:
Electronic locking system with pressure function and various forms of data carrier integration.



SAFE-O-TRONIC® lock:
Variable locking system offering different options for operation – from PIN codes to transponders right up to NFC technology.

Electronic online locking systems



GAT-Lock 5010 with central information terminal:
The compartment is opened by data carrier directly on the locker, whereas the central display provides information about which compartments are in use and which compartments are free.



METRA locking system with central control unit:
The compartment is opened centrally by either data carrier or fingerprint biometric scan.



It's your choice.

The Prefino series offers the right locker for every application. Because we set great store by variability. You can bet our range has the right model for you, too.

Your C+P furniture consultant will be glad to give you more information and to demonstrate the ideal solution for you.

The S 7000 Prefino series from C+P is available ...

... in compartment widths

of 300 or 400 mm, with one, two, three or four compartments (compartment width 400 mm: up to three compartments)

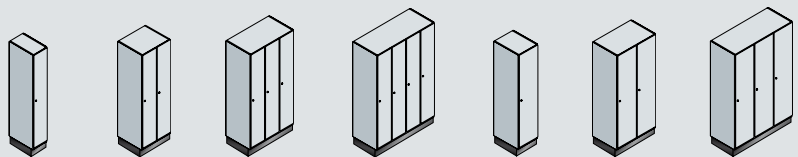

... in different designs

with continuous doors and two, three, four, five or six lockers on top of each other

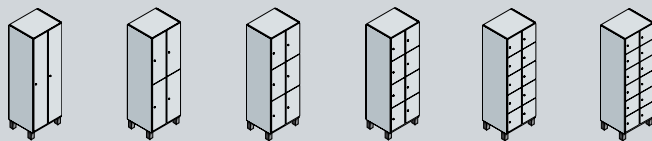

... in a wide range of front and door finishes

e.g. in steel or stainless steel, wood decor or real-wood veneer, enamelled glass or utterly individual with printed glass or vectogram cut into HPL

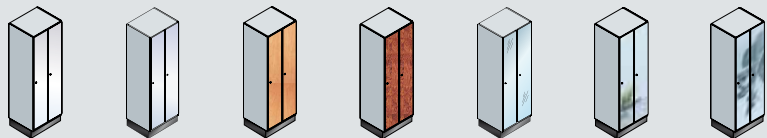

... on various mounts

on feet or with a base, wall-mounted or on an on-site plinth



... with sub-frames, corner solutions, panels and installation sloping roofs

with integrated bench, storage box, panels for interior and external corners, mirror or technology panels for the front faces, and installation sloping roofs with or without lighting

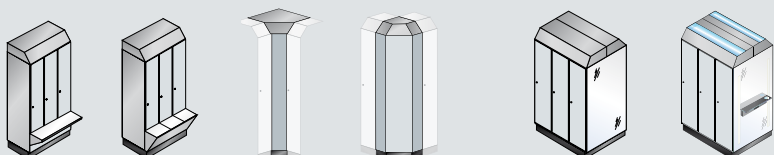

... as solutions for special requirements

e.g. with doors that close together, with security compartments, Z locker versions or for special tasks as "communication islands" or bag lockers

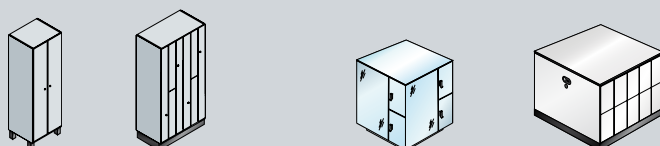

An ingenious combination.

A wide choice of attractive coatings and surfaces are standard at C+P. Or we can customize the colour or surface finish to your individual requirements. You will find the entire range and additional information about colour design in the latest catalogue. Have fun choosing!



Carcass and door colours:
The Prefino series offers numerous additional options besides the classic white aluminium and black-grey carcass colours.



Real-wood veneers:
The right choice for representative areas. Many contemporary veneers are available.



HPL decor fronts:
Contemporary decors are available for HPL fronts and blanking panels.



Glass colours:
Doors made of colourfully enamelled glass with gloss or matt front.

Prefino doors



Steel doors:
Double-skin and insulated, with the classical elegance of a peerless material.



HPL doors:
Made of high-pressure laminate, 13 mm thick, available in many attractive decors.



Doors with real-wood veneer:
The right choice for sophisticated surroundings.



Glass doors:
Sophisticated door variant made of 8 mm-thick, colourfully enamelled toughened safety glass.

Incidentally:

C+P is the specialist for tasteful and efficient furnishings and fittings made of steel. We have been specializing in the field for decades. So it is no wonder that our customers have enabled C+P to become the market leader in numerous product segments.

You can obtain more information about the Prefino range and the address of a specialist dealer near you by calling

+ 49 (0) 64 65 / 919-340

or sending an email to **sales@cp.de**

C+P Möbelsysteme GmbH & Co. KG

Boxbachstraße 1 · D-35236 Breidenbach/Germany

Tel. +49(0)64 65/919-340 · Fax +49(0)64 65/919-349

E-Mail sales@cp.de

Internet www.cp.de

Furniture for people

