

Glass Door Furniture

Top Pivot Patch Fitting (K101)



- Part Code:** K101
- Cover Finish:** Satin Stainless Steel
- Weight:** 0.55kg
- Application:** Suitable for use with 10mm and 12mm thick toughened glass doors
- Duty:** Doors with Heavy traffic use
- Systems Application:** Polar/Orbis frameless glass door without a door frame

Top View

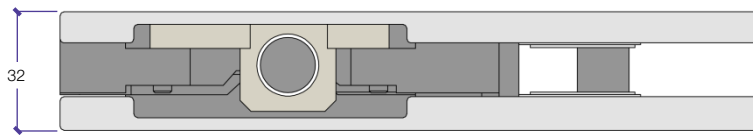

Back View

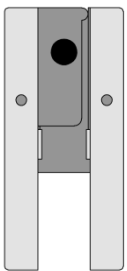

Side View



Front View

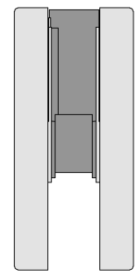

For installation instructions, see Komfort website (video) and the product's internal packaging.



KOMFORT

National Specifier Support Line Tel: 0871 781 2700 ♦ E-mail: tech@komfort.com ♦ Internet: www.komfort.com