



Promat Industry UK
Glazing for Life®



www.promat-glass.co.uk



Who Are Promat?

Promat Industry is an acknowledged leader in the manufacture and supply of high performance insulation, acoustic and passive fire protection products. We are proud to provide a range of products that are trusted, proven and installed worldwide, across a diverse range of industries and applications.

Promat Industry is a key part of the worldwide network of the Etex Group who have a presence in **45 countries**, operating **107 production sites** and **employing more than 15,000** skilled and dedicated professionals. In 2016, group **turnover was in excess of €2.9 billion**.



worldwide presence

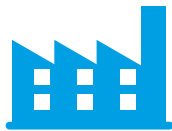

107 production sites



over 15,000 employees



Etex 2016: €2.9 billion

For more than fifty years Promat has been synonymous with high quality solutions for a variety of industrial applications. Our market leadership is based on engineering competence, a uniquely broad range of products and systems (across the whole temperature range) and a first class service at every stage of your project.

Benefits

- Proven performance
- Excellent fire, acoustic and thermal insulation
- Lightweight
- Easy to install
- Excellent workability
- Sustainable

Our accreditations:



Our Mission - "To lead in sustainable, fire, thermal and acoustic solutions by consistently exceeding customer expectations"

Promat Glass

Promat's wide range of glass products and systems provide proven and assured levels of fire and smoke protection for fire resistant glazing applications within a wide range of building sectors.

Promat's knowledge and expertise provides clients with fully integrated design solutions that deliver required levels of fire protection across refurbished and new build properties.

Promat works closely with a wide range of customers, providing comprehensive support and advice including; Glass Specifiers, OEM Partitions and OEM Door companies.

The Heywood Site

The Promat Glass processing facility, named The Innovation Centre, is based in Heywood, which opened in 2015 to accommodate an expanding customer base and product range. The site is accredited with:

- Quality: ISO 9001
- Environment: ISO 14001
- Health and Safety: OHSAS 18001



RIBA Approved CPD

Promat offers a RIBA approved Glass CPD, named 'The Burning Question'. The 60 minute long presentation includes a range of topics relating to fire-resistant glass, such as regulations, types of glass and how to specify with confidence.

Trade Memberships

Promat continues to push the development of fire protection systems further, constantly searching for improvement for the construction industry as a whole through representation at trade associations, BSI and CEN technical committees. The glass related trade memberships include:



Glass and Glazing Federation

Glass and Glazing Federation (GGF)

Promat is active in the Fire Resistant Glass & Glazing Group (FRGG) who have undertaken a number of initiatives, the latest of which is the training of glass/glazing installers to a level of competency for the installation of fire resistant glass.



British Woodworking Federation (BWF)

Promat is actively involved in the management committee of the Fire Door Division, which covers the full plethora of joinery, including timber fire doors with glass vision panels.

For more information visit www.promat-glass.co.uk

Types of Glass

Integrity Non-insulating (E)

Integrity glass has the ability to withstand fire exposure to one side without transmission of the fire as a result of flames or hot gasses. It acts as a physical barrier to stop the fire.

Integrity and Low Radiation (EW)

The ability of a material not to collapse in order to prevent the passage of flame to limit the heat transfer through the material.







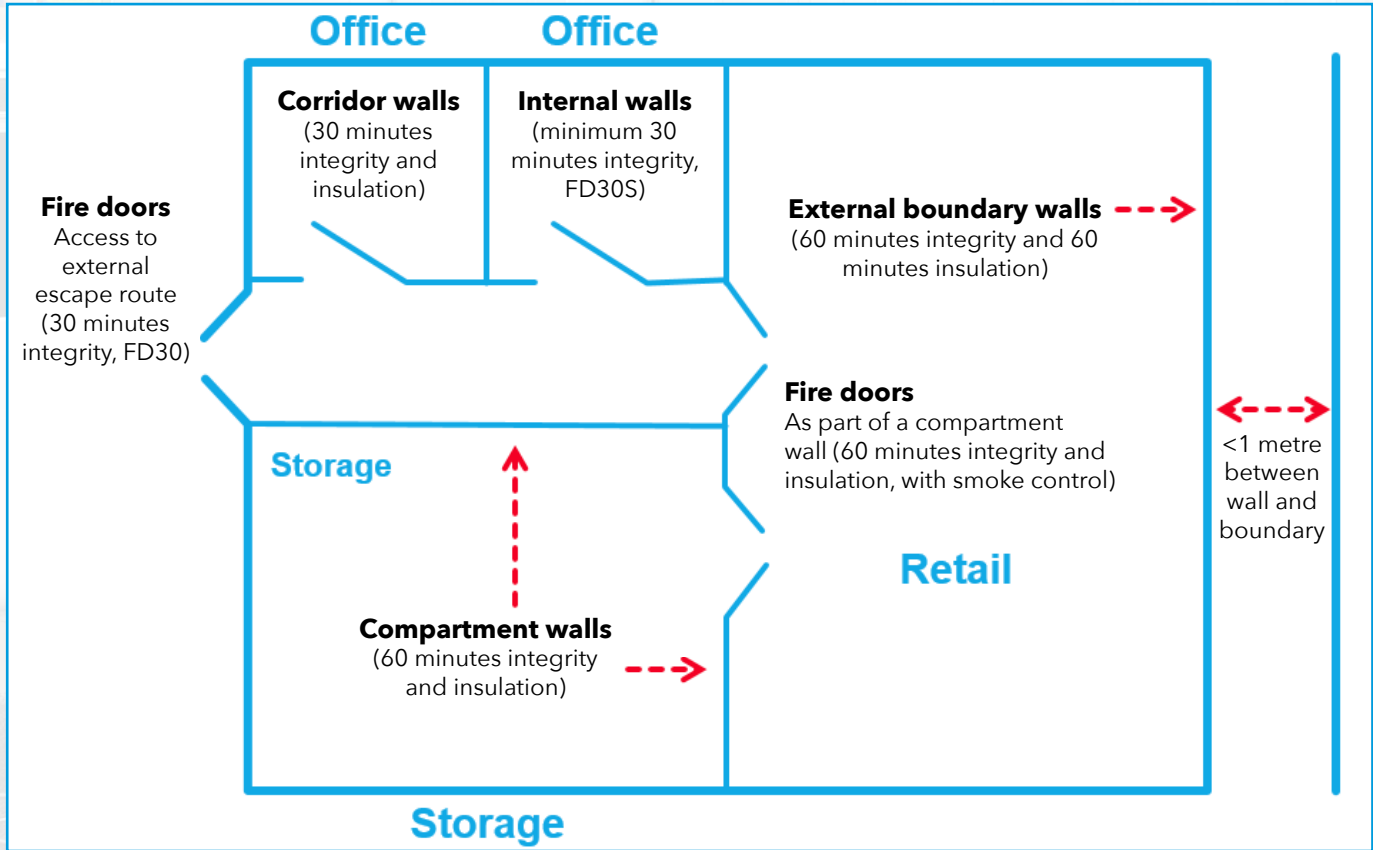

Integrity and Insulation (EI)

The ability of a material to withstand fire exposure on one side without transmission of fire to the unexposed side by limiting heat transfer due to conduction, convection or radiation (in addition to integrity). It maintains a mean temperature of 140°C and maximum temperature of 180°C on the non-fire side of construction.

Where to Use Fire-Resistant Glass



Product Selector

 <p>Integrity</p>		 <p>30 to 60 Minutes</p>	<p>PYROCET®</p> <p>PYROSEC 19®</p> <p>SMOKESTREAM®</p>
 <p>Integrity and Radiation</p>		 <p>30 to 60 Minutes</p>	<p>PYROSEC® (7, 9, 12)</p>
 <p>Integrity and Insulation</p>		 <p>30 to 120 Minutes</p>	<p>SYSTEMGLAS®</p> <p>SYSTEMGLAS® F1</p> <p>PYROSEC® (16+)</p>

PYROCET®

The PYROCET® range comprises a monolithic toughened float glass, which goes through a modified toughening cycle. Offering integrity only, the altered structure allows it to perform in excess of 90 minutes (frame dependent) where ordinary toughened glass cannot. PYROCET® is popularly used across the secure public sector and is currently unsurpassed. It is ideal for use in steel screens, timber screens, timber or steel doorsets and Insulating Glass Units (IGU's).

PYROCET® XPT: Installation into timber doors and screens offering 30 minutes fire integrity. It can be supplied in 6 and 10mm 'clear' glass and 6mm body tinted options are available (bronze, green and grey).

PYROCET® XPS: Ideal for steel frames and doors, available with 30, 60, and 90 minute fire integrity. It can be supplied in 6 and 10mm 'clear' glass and 6mm body tinted options are available (bronze, green and grey).

PYROCET® R: For reduced radiation (EW) offering 30 and 60 minute fire integrity, it is supplied only as 6mm clear glass product.

Performance

- Can achieve up to 90 minutes integrity fire resistance into steel screens
- Toughened Safety glass with a Class A rating
- Fully BS Certifire accredited into Timber/ Steel (Doors/Screens)

Appearance

- Unwired for clear vision
- Variety of finishes and glass substrate Body Tint & Obscured
- Can be manufactured into IGU's for additional properties (Acoustic, Low E, Solar Control)

Project Snapshot



Church, Bournemouth, UK

A refurbishment of Methodist Church in Bournemouth.

Timber frames used to complement the decor and design of the Church.

Aesthetically pleasing unwired glass that projects light from large stained glass windows through to the foyer.

Glass used as both windows and door panels to form an integrated system.

Strong acoustic performance to contain noise during services.

Applications

- Commercial offices
- Retails outlets, factories and hotels
- Universities and schools
- Hospitals/healthcare
- Government buildings
- Airport terminals
- Museums, libraries and leisure facilities
- Internal partitioning, fire doors, atria and external curtain walling

Availability

- UK produced, Available on shorter lead times compared with competitor products
- Nationwide deliveries available



Contact us to book an appointment for our RIBA approved Glass CPD presentation.

PYROSEC® 19

PYROSEC® 19 is a modified toughened 19mm fire resistant/physical attack resistant glass developed for use in the UK's most secure institutions as vision panels in doors, side screens and walls. The dual-purpose nature of the glass as a fire-resistant and physical attack barrier means PYROSEC® 19 is ideal in a public sector environment.

It is fully transparent and therefore allows an unobstructed view within secure public sector facilities. Where the glass is required to be used for physical attack reasons only (no fire protection requirement) PYROSEC® 19 can be used as part of a non-fire rated unit with toughened or laminated glass types to safeguard against physical attacks.

Performance

- Fire resistance and severe physical attack ideal for public sector buildings
- High modification toughened product
- Suitable for fire doors and screens E30 - E60 fire resistance
- Class A safety with Impact resistance to BS and EN standards including a BM Trada accreditation

Appearance

- Clear glass product for better observation
- Smooth processed edge finish
- Unwired for clear vision

Project Snapshot



A new build care home facility in Hartlepool.

Glass used as windows and door panels to form an integrated system.

Aesthetically pleasing unwired glass to project natural light effectively through the corridors.

Timber frames used to complement the internal decor and environment.

Care Home, Hartlepool, UK

Applications

- Prisons and secure facilities
- Hospitals and social care homes
- Police stations and banks
- Universities and schools
- Government buildings
- Airport terminals

Availability

- UK produced
- Nationwide deliveries available



Visit www.promat-glass.co.uk for further information, literature and samples.

SMOKESTREAM®

SMOKESTREAM® combines a modified toughened glass with a glazing system designed and tested to provide a permanent passive smoke curtain. It is an unobtrusive method of controlling the passage of smoke to pre-determined extraction points and involves minimal maintenance. The system is suitable for installations in new or existing buildings where smoke control is a requirement.

Performance

- A fire-resistant glass barrier to control the spread of smoke
- E30 - 90 fire performance
- Quick and easy to install

Appearance

- Unwired for clear vision
- Smooth processed and pre drilled holes
- Neatly finished Promat bracket system is available with glass

Project Snapshot



A refurbishment project for a large airport terminal.

Discretely installed to steel screens and mounted to the roof.

An unobtrusive system using unwired glass that is likely to be unnoticed by members of the public.

Airport, UK

Applications

- Commercial offices
- Retails outlets and factories
- Universities and schools
- Hospitals/healthcare
- Government buildings
- Airport terminals
- Railway stations
- Shopping Malls

Availability

- UK produced
- Nationwide deliveries available



Got a technical enquiry? Telephone us on 0800 588 4444

PYROSEC®

PYROSEC® is a leading type of fire integrity and insulation glass ideal for use in timber screens, timber doors, steel screens, steel door sets and Insulating Glass Units (IGU's). It can be laminated with 7.5mm pane to one or both sides using a single PVB interlayer.

Performance:

- Can achieve up to EW90 minutes low radiation fire resistance into timber doors
- Larger format test evidence available in to Timber, Steel (Doors/Screens) and Aluminium (Screens)
- E30 - EI120 fire performance
- Can be manufactured into IGU's for additional properties (Acoustic, Low E, Solar Control)
- Tested to big sizes therefore is ideal for covering large surface areas

Appearance:

- Clear, Low Iron or Acid edge finish
- Variety of glass thicknesses for E and EI performance
- Can be clear line butt jointed

Project Snapshot



Refurbishment of a reputable Jewellers store in Blackpool.

Glass used as windows and door panels to form an integrated system.

Aesthetically pleasing unwired glass that doesn't obstruct the product display.

Jewellers Shop, Blackpool, UK

Applications

- Commercial offices, escape corridors and stairwells
- Retail outlets, factories and hotels
- Universities and schools
- High specification residential properties
- Hospitals/healthcare
- Government buildings
- Airport terminals
- Museums, libraries and leisure facilities

Availability

- Cut from stocked products for shorter lead times compared with competitor products
- Nationwide deliveries available



Request literature or a sample by emailing sales@promat.co.uk

SYSTEMGLAS®

SYSTEMGLAS® is a butt jointed integrity and insulation glass. It is the first system of its type introduced in the UK and it eliminates the need for the heavy and unsightly frames required by conventional systems so architects can achieve unlimited runs of aesthetically appealing glazing without any compromise to the fire resistance. Capable of providing 30-120 minutes fire resistance, SYSTEMGLAS® includes glazing, slim profile perimeter framing and glazed doors, to create a fully-certified protection solution. Glazed fire compartmentation can now be created around stairs, lift enclosures, corridors and many other areas where solid materials have traditionally been used, giving architects greater freedom in the design of their buildings. It can be installed using steel, timber or Promatect® H calcium silicate board frames.

SYSTEMGLAS® complies with, or exceeds, recognised UK and European standards and regulations relating to passive fire protection. The use of fully trained Approved Fabricators to install the system ensures complete peace of mind.

Performance:

- One of the first fire resistant clear line butt jointed glass partition systems
- Integrity and Insulation fire resistance for EI30 - EI120
- High impact and Safety resistance with BS accreditation
- External grade glass types available for UV stability

Appearance:

- Complete system with slim line frame and can be concealed-frame perimeter fixed
- Matching SYSTEMGLAS® door sets available
- Can be installed horizontally for larger glass spans
- Clear, Low iron and acoustic glass types available

Project Snapshot



An I.T software centre located in Galway, Republic of Ireland.

Butt jointed frameless installation to complement the modern decor and open-plan layout of the building.

DDA compliant glass manifestation for blind and partially sighted people, as well as providing a limited amount of privacy.

Aesthetically pleasing unwired glass to project lots of natural light throughout the building.

IT Software Centre, Ireland

Applications:

- Commercial offices
- Retail outlets
- Hotels
- Universities and schools
- High specification residential properties
- Hospitals/healthcare
- Government buildings
- Airport terminals
- Museums, libraries and leisure facilities

Availability

- Trusted network of approved installers
- Cut from stocked products for shorter lead times compared with competitor products
- Nationwide deliveries available



Visit www.promat.co.uk/systemglas-specify to download our SYSTEMGLAS® Specifiers Guide

SYSTEMGLAS® F1

SYSTEMGLAS® F1 consists of two toughened float glass panes encapsulating an intumescent fire-resistant gel. At the circumference of the composite glass, there is a profile edge which connects the two glass plates with each other that holds the fire-resistant gel. This butt jointed solution is transparent, lightweight and has strong acoustic performance for a range of applications.

Performance

- New intumescent gel technology for high fire resistance
- A light weight option
- Integrity and Insulation fire resistance for EI30 - EI120
- Toughened glass properties for Class A safety
- UV stable with good thermal properties
- Excellent acoustic performance

Appearance

- Large format spans up to 1500 x 3500mm
- Aesthetic screen printed outline butt joint
- Complete system with slimline frame and can be concealed-frame perimeter fixed
- Interchangeable glass types for decorative finishes

Project Snapshot



A public sector new-build library located in Ramsgate, Kent.

DDA compliant glass manifestation for blind and partially sighted people.

Aesthetically pleasing with lots of natural light projected throughout the building.

Large glass panels used to cover a wide surface area.

Library, Kent, UK

Applications

- Commercial offices
- Retail outlets
- Hotels
- Universities and schools
- High specification residential properties
- Hospitals/healthcare
- Government buildings
- Airport terminals
- Museums, libraries and leisure facilities

Availability

- Trusted network of approved installers
- Cut from stocked products for shorter lead times compared with competitor products
- Manufactured to finished sizes
- Nationwide deliveries available



Visit www.promat-glass.co.uk to download technical data sheets.

PROMATECT® H

Promat® H is a calcium silicate based fire protective construction board with cement binder, resistant to moisture, of stable dimensions, large format and self-supporting. It can be used as a framing material or to conceal a frame to provide the appearance of a frameless system. This creates an aesthetically pleasing and modern appearance whilst still ensuring it is still an integrated fire-resistant system.

It is produced with quality assurance according to the standard ISO 9001.

Execution of construction elements for construction and technical fire protection according to EN standard in all the fields of building construction and industrial construction.

Performance and Appearance

- Large-sized, self-supporting
- High mechanical strength
- Good thermal insulation
- Effective noise-proofing
- A1, non-combustible in accordance with EN 13501-1
- Easy to shape and work
- Strong chemical resistance
- Hygroscopic and vapour-permeable
- Unaffected by humidity
- Retains shape stability and load capacity in humid conditions
- Replaces or conceals frames in glazing systems to create a modern look

Project Snapshot

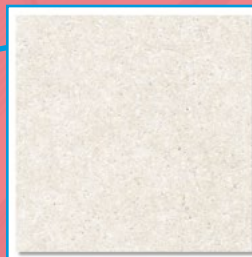

Promat® H secreted in the ceiling instead of a traditional frame.

Aesthetically pleasing with lots of natural light projected throughout the building.

Large glass panels used to cover a wide surface area.

Office, London, UK

Applications

- Commercial offices
- Retail outlets
- Hotels
- Universities and schools
- High specification residential properties
- Hospitals/healthcare
- Government buildings
- Airport terminals
- Museums, libraries and leisure facilities

Availability

- Trusted network of approved installers
- Cut from stocked products for shorter lead times compared with competitor products
- Nationwide deliveries available



Email sales@promat.co.uk or phone 0800 588 4444 to request a quotation.

Notes Page

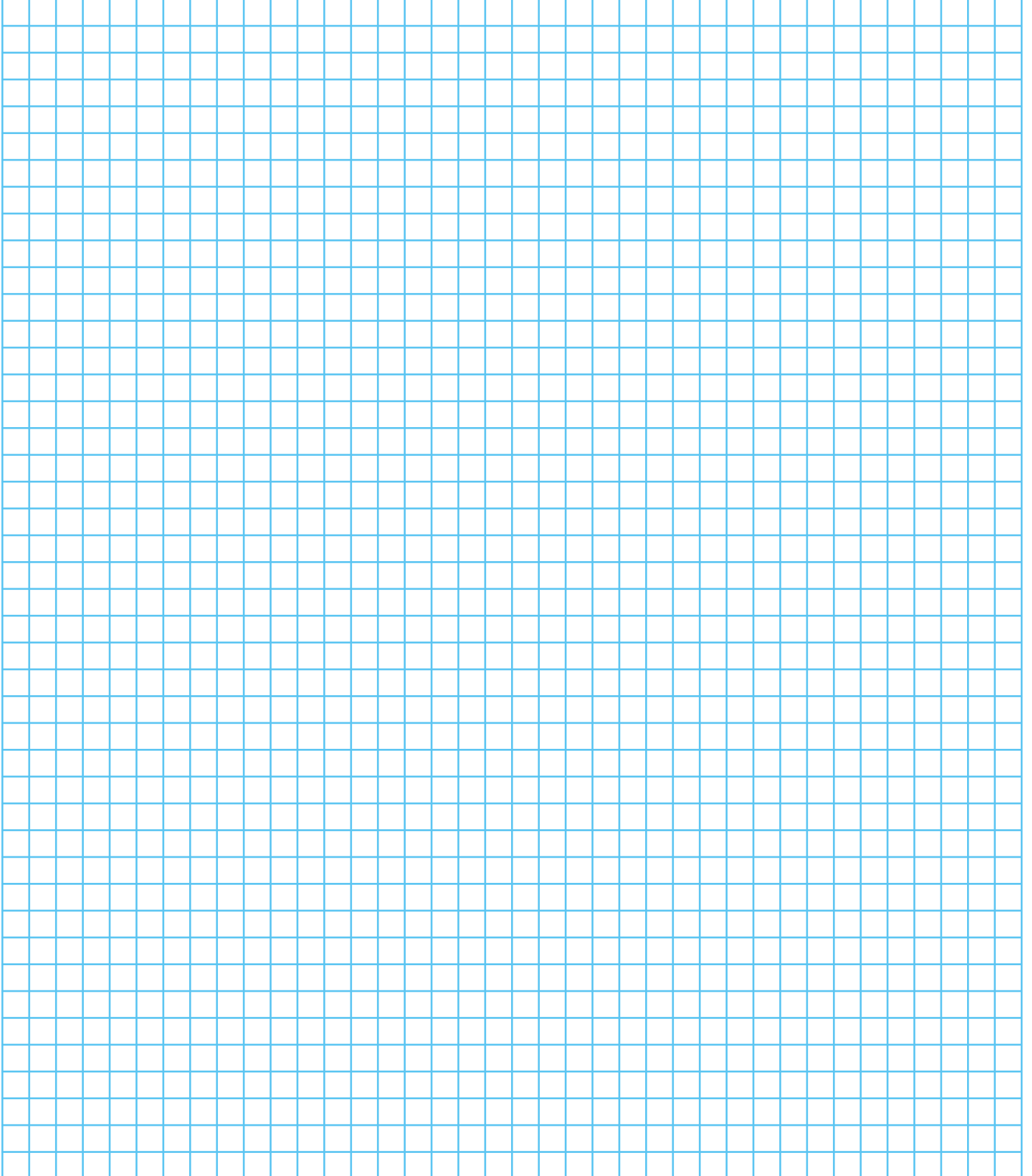

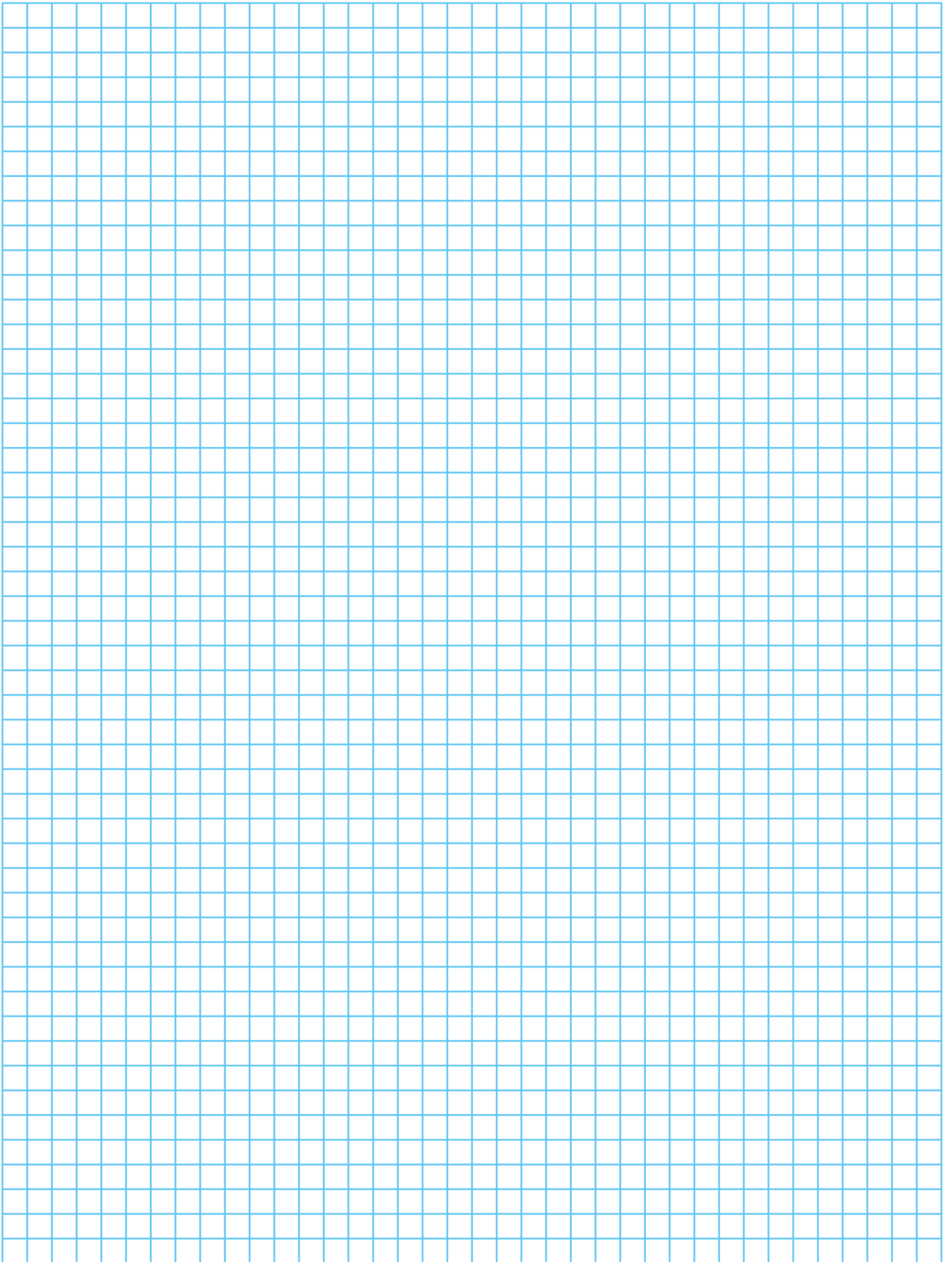

Notes Page

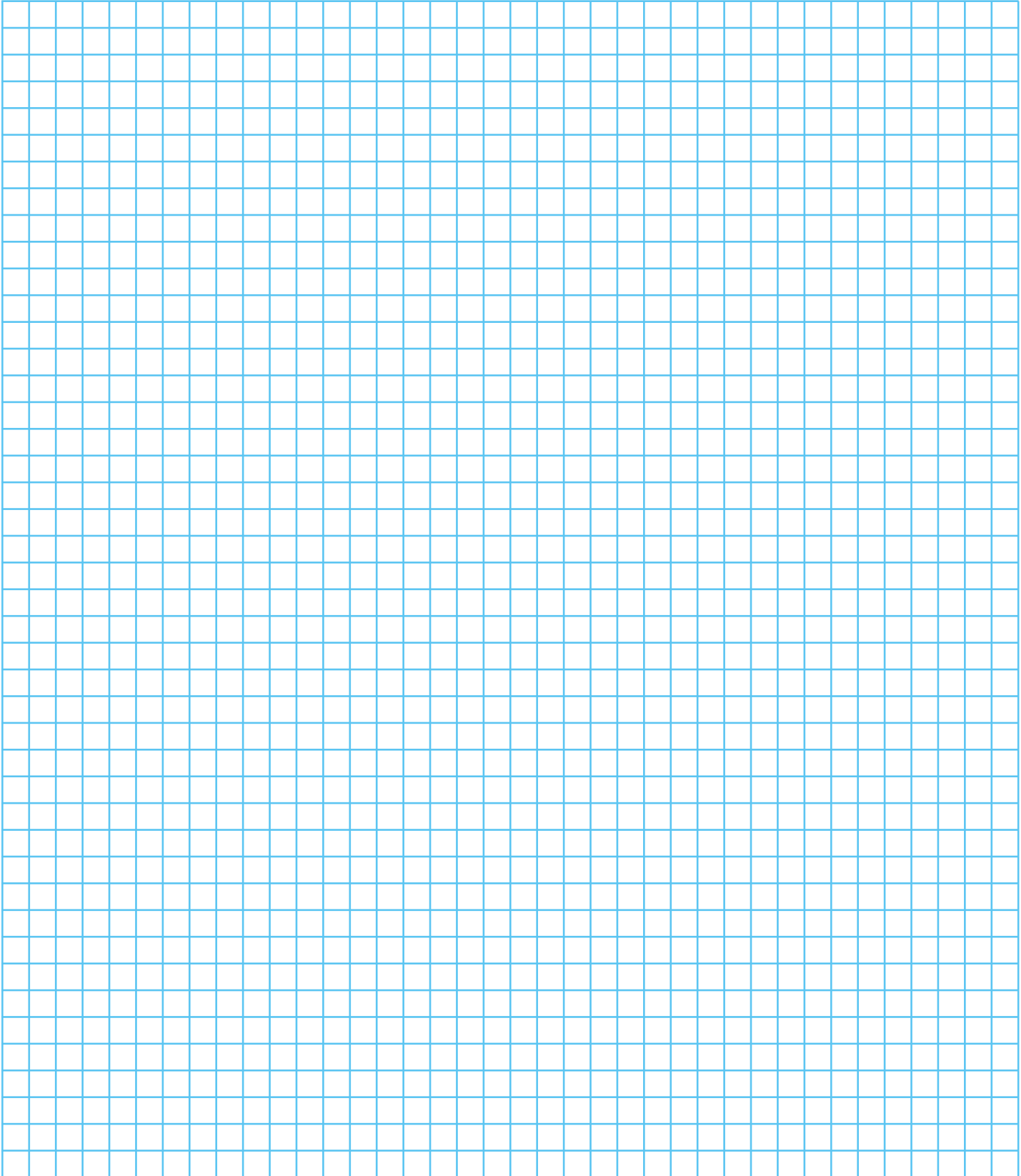

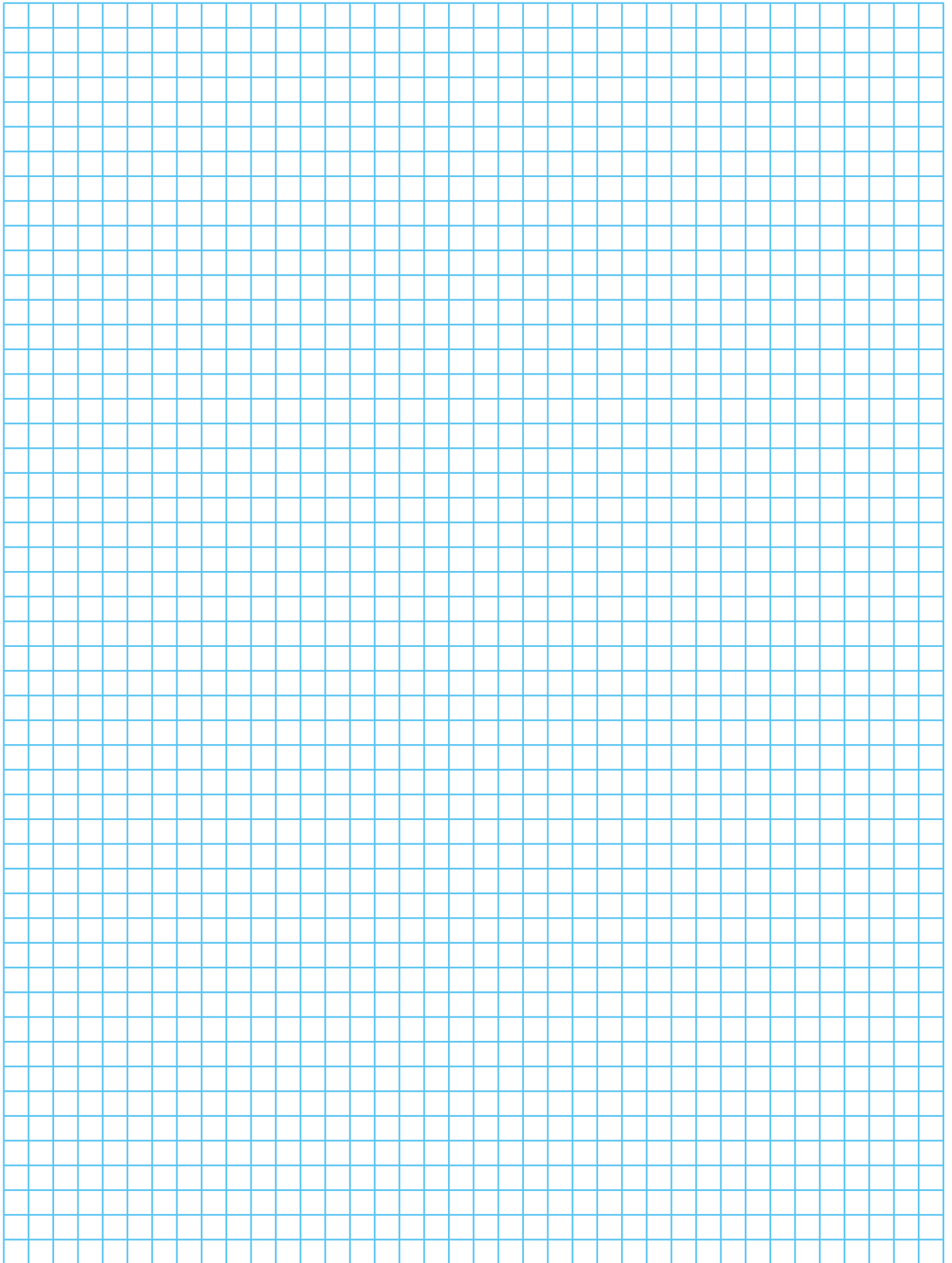

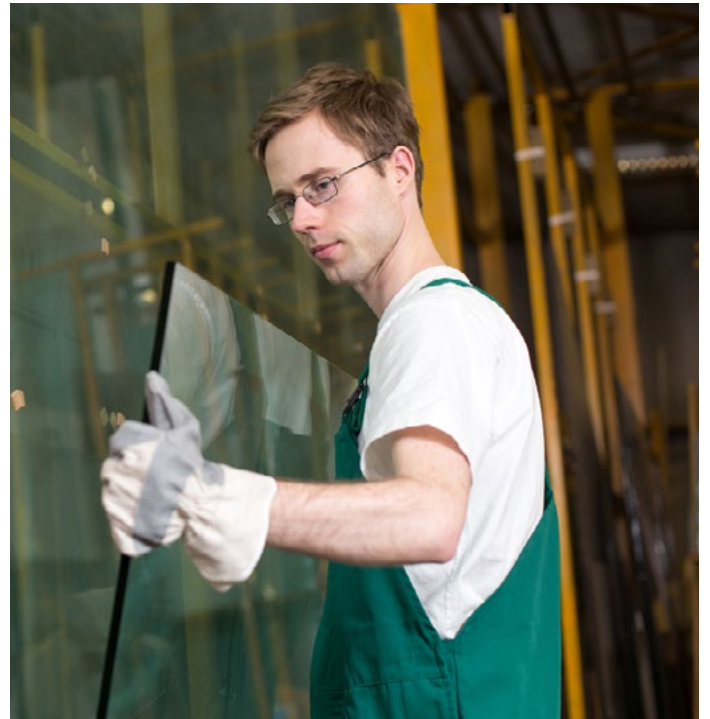

Promat UK Limited

B1 The Innovation Centre
Heywood Distribution Park
Pilsworth Road
Heywood
Lancashire
OL10 2TS

T +44 (0) 800 588 4444
E sales@promat.co.uk

www.promat-glass.co.uk