

52mm DG Sonik Door

Installation of Cranked Guardsman Pull Handle

Installation Instructions:

1. Insert the **5.5mm Collar [1]** into both sides of the glass door, locating into the **aluminium door frame**.
2. Screw the **Fixing Bolt [2]** along with a **Washer [3]** (on each side of the door) through the **aluminium door frame** to the **Fixing Bolt Side (Male) Handle [4]**.
3. Offer up the **Fixing Pin Side (Female) Handle [5]** to the **Fixing Bolt** free end.
4. Tighten the **M6 Grub Screws [6]** to secure the **Female Handle** to the **Fixing Bolt**.



720mm, 1240mm and 1760mm Options

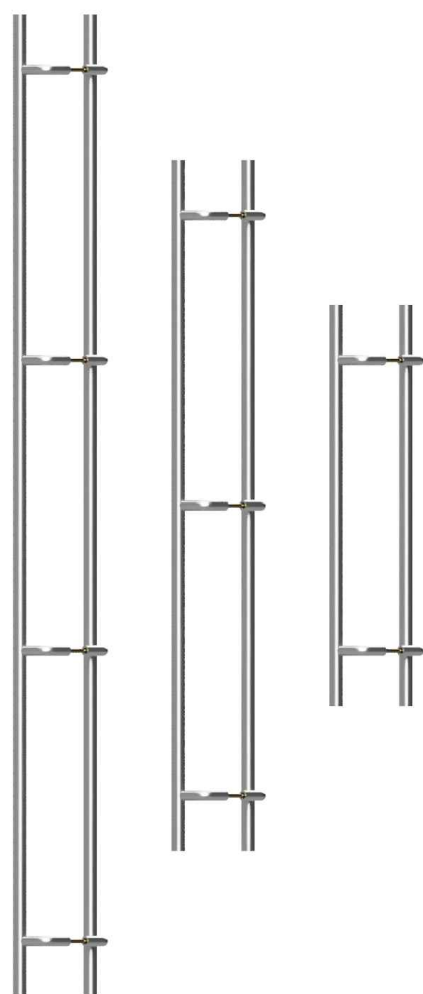

SI1760G, SI1240G or SI720G

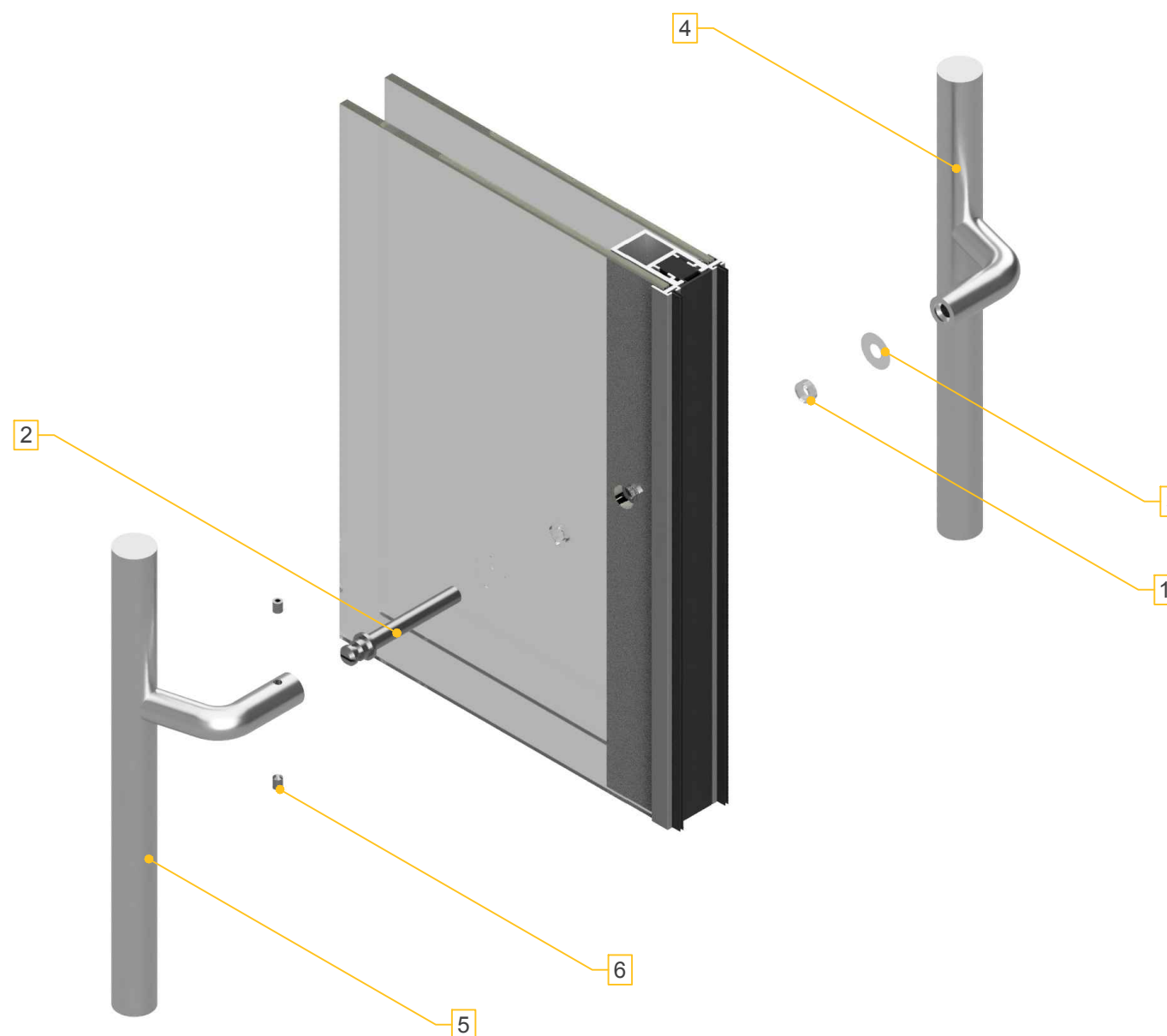

52mm DG Sonik Door

Installation of Offset Pivot Top

Installation Instructions:

1. Install the **two Spirol 8 x 40mm Pins [1]** fully into the support bracket within the door, take note to **not install** pins into the **threaded holes**.
2. Peel off the adhesive backing on the foam **DA60-22 gasket [2]** and apply to **DA60-21 plate [3]**.
3. Slide the above assembly onto the Spirol pins until **the foam pad touches the glass**.
4. Take the **upper arm [4]** and also slide onto the Spirol pin until part [4] meets part [3].
5. Take the **three M8 Bolts [5], [6], [7]** and tighten with a **6mm Allen** torque wrench bit to **25N/m**.
6. If not already fitted, push nylon **washer [8]** into **upper arm [4]**.
7. Slide upper frame **fixing bracket [9]** into the pre-machined slot in the door frame head and fix with 4no. **colour matched 381 screws [10]**.
8. Offer up **Cylinder DA60-6 [11]** to upper bracket and secure with **3no. M4 x 15mm screws [12]**, ensure the grub screw holes are **visible** from the front of the door for ease installation.
9. When door has been dropped onto floor spring spindle and cantilevered into position so that the upper arm of the door [4], the frame fixing arm [9], and the cylinder [11] are in alignment, push the **DA60-10 Pin [13]** into this assembly from above or below, align flush with the upper frame bracket [9] and the secure with two **M5 Dogpoint [14]** grub screws fully locate into the pin.



DA60-5



SPIR8x40HBK (2)



DA60-6



M8.MSKTA280.35
M8.MSKTA280.45
M8.MSKTA280.55



DA60-7



M5.MDPSS.12 (2)



DA60-9



M4.MCSKH.16 (3)



DA60-10



381 (4)



DA60-21



DA60-23

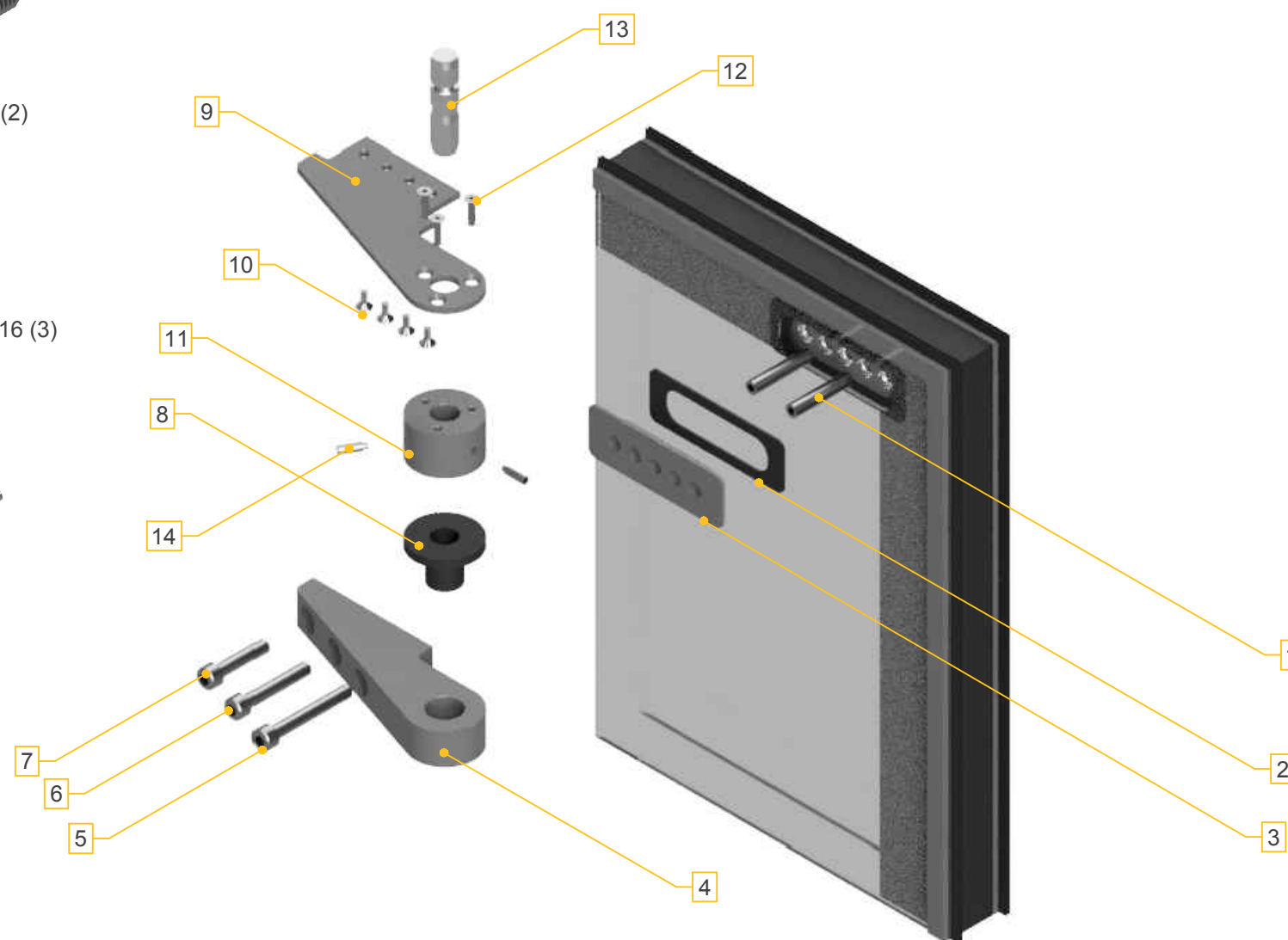

52mm DG Sonik Door

Installation of Offset Pivot Bottom

Installation Instructions:

1. Install the two **Spirol 8 x 40mm Pins [1]** fully into the support bracket within the door, **take note to not install pins into the threaded holes.**
2. Peel off the adhesive backing on the **foam DA60-22 gasket [2]** and apply to **DA60-20 [3]** plate.
3. Slide the above assembly on the Spirol pins until the **foam pad touches the glass.**
4. Take the **lower arm DA60-2 [4]** and also slide onto the Spirol pins until it touches the **plate [3]**.
5. Take the **three M8 Bolts [5, 6, 7]**, tighten with a **6mm Allen Torque wrench bit to 25N/m. Ensure the 55mm bolt [5] is screwed into the the closest hole to the pivot [5.1], and the 35mm bolt [7] into the furthest one [7.1].**
6. Attach **magnet [8]** to the **metallic cap [9]** and drop it onto the lower arm to complete the assembly.

