

KEYLESSH2

THE SIMPLE HASP

EXPERIENCE THE PERFECT LOCKS

SIMPLY PERFECT. PERFECTLY SIMPLE.

SIMPLE to install and operate, our hasp lock is perfect for assigned or shared use in wet or dry areas.

SUSTAINABLE with a solid metal design and no batteries, wires, or harmful waste these locks qualify for two LEEDV4 credits.

OUR CLIENTS



amazon

BOEING

Capital One



Coca-Cola



EQUINOX

facebook



Google

HYATT



LIFETIME FITNESS



Mercedes-Benz



PEPSICO



REBEL



VISA

KEYLESSH2

ARCHITECTURAL SPECIFICATIONS



PART NUMBER:
KEYLESSH2-SN
STANDARD FINISH:
SATIN NICKEL



PART NUMBER:
KEYLESSH2-MB
PREMIUM FINISH:
MATTE BLACK
MUNSELL N2/
MUNSELL N9/



PART NUMBER:
KEYLESSH2-MW
PREMIUM FINISH:
MATTE WHITE
MUNSELL N9/

10% color discrepancy and custom pricing options apply.

- Shared (temporary) or assigned (permanent) use, depending on padlock
- Compatible with wood, glass, plastic, phenolic and metal locker doors
- Zero operating expenses - No batteries or wires
- LEED V4 certified - adds 2 LEED credits

- Ergonomic non-slip grip knob
- The hasp accepts padlock shackles up to 11mm thick
- IP69K - Complete dust and water resistance
- Rust material resistance - perfect for humid environments
- Strong 100% metal for long-term heavy-use - no plastic components

- Accommodates doors 1-23mm thickness
- Disinfected by misting with a liquid that is 70%-80% alcohol without damaging the surface of the lock
- **Immediate live response during business hours - no run around.**
(sos@keyless.co or 972.331.2770)

TOP VIEW

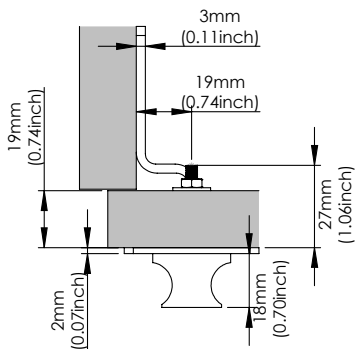

SIDE VIEW

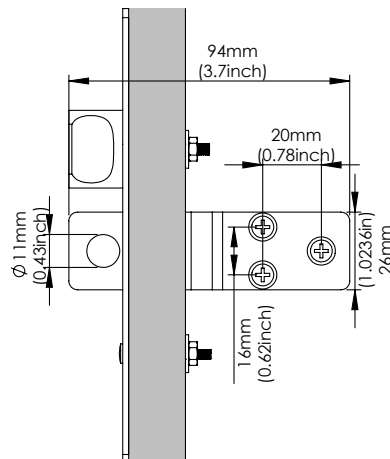

FRONT VIEW

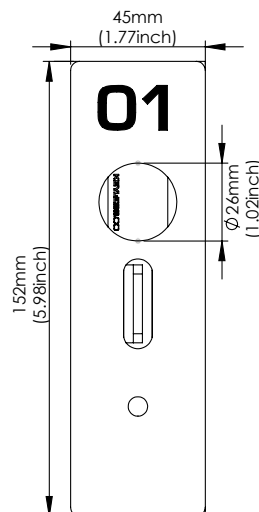

DOOR ROUTING

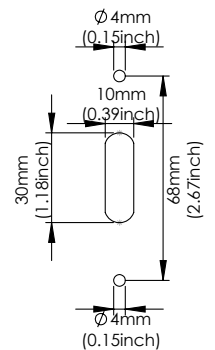

Manufactured By:

KEYLESS.CO

1825 W. Walnut Hill Ln., Suite 102, Irving, TX 75038, USA | +1 972-331-2770 | info@keyless.co | www.keyless.co | V: 6/17/2020